

BOMFORD

B49FM B54FM B58FM

- ✔ 4.9m, 5.4m or 5.8m reach
- ✔ Front mounted
- ✔ Low profile design, for good forward visibility
- ✔ 125 l/min fully independent hydraulic system
- ✔ Left and right hand side cutting

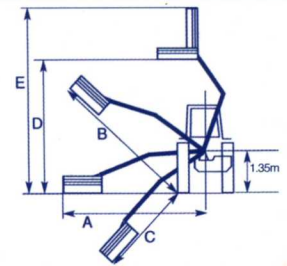

	B49	B54	B58T
A	4.9m	5.4	5.8
B	4.9m	5.4	5.8
C	3.4	3.8	3.6
D	4.2	4.8	5.0
E	6.1	6.5	6.7

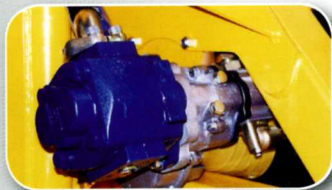

Features

Reach
Tractor Size hp / Kgs (mm)
Mounting system
Breakaway
Power slew
Twin pump hydraulic system
Gear pump hydraulic system
Parallel arm geometry
Fwd reach arm
Cable controls
Electric Proportional Controls (EPP)
Weight inc head & oil
Oil tank capacity
Head float / Arm float

	B49	B54	B58T
Reach	4.9m	5.4m	5.8m
Tractor Size hp / Kgs (mm)	70/2700	70/3000	70/3000
Mounting system	Linkage	Linkage	Linkage
Breakaway	Hydraulic	Hydraulic	Hydraulic
Power slew	opt	std	std
Twin pump hydraulic system	std	std	std
Gear pump hydraulic system	125L/min = 65hp	125L/min = 65hp	125L/min = 65hp
Parallel arm geometry	n/a	n/a	n/a
Fwd reach arm	n/a	opt	opt
Cable controls	std	std	std
Electric Proportional Controls (EPP)	opt	opt	opt
Weight inc head & oil	1255Kg	1247Kg	1247Kg
Oil tank capacity	227L	227L	227L
Head float / Arm float	std / opt	std / opt	std / opt